

 ***NORTH SILVER 1440***



Built to last

Basic requirements for high-speed all weather boat include reliability, safety, seaworthiness and habitability. Designing NorthSilver 1440 we set ourselves a mission to optimally meet all of them in order to provide the owner with smooth user experience which would last for many years.

This vessel possesses the classic shape of Scandinavian offshore cruisers but unlike many others is completely metal. The planing hull with high freeboard and deadrise, the superstructure with complex geometry and full-size flybridge as well as all bulkheads are made of high quality aluminum alloy. It is hardly evident from the vessel's

exterior since neatly bent elements, perfectly welded seams, and flawless paint job make it indistinguishable from similar fiberglass boats. We have invested our vast experience into creation of this flagship and it exposes all the benefits of aluminum yachts to full extent.

Versatile NorthSilver 1440 is designed for daily completing wide range of tasks including recreation and commuting, fishing and scuba diving, exploration and professional duties. She is aimed for cruising in all kinds of conditions and indispensable in the areas without extended infrastructure. She can come to help when most of the leisure yachts

tend to stay in the marinas because of the weather. That is why she is perfect for those kinds of cruises when one expects from the vessel unrivaled self-sufficiency along with high average cruising speed. NorthSilver 1440 is complete tool for the express expeditions when your sought after travel meets lack of time.

Choosing NorthSilver 1440 you get reliable, comfortable, and durable yacht. This type of vessels is not prone to design obsolescence and with the due maintenance she will serve for several generations of the owners without losing her best features.

www.northsilver.com





GARMIN

NORTH SILVER 1140

NORTH SILVER

00



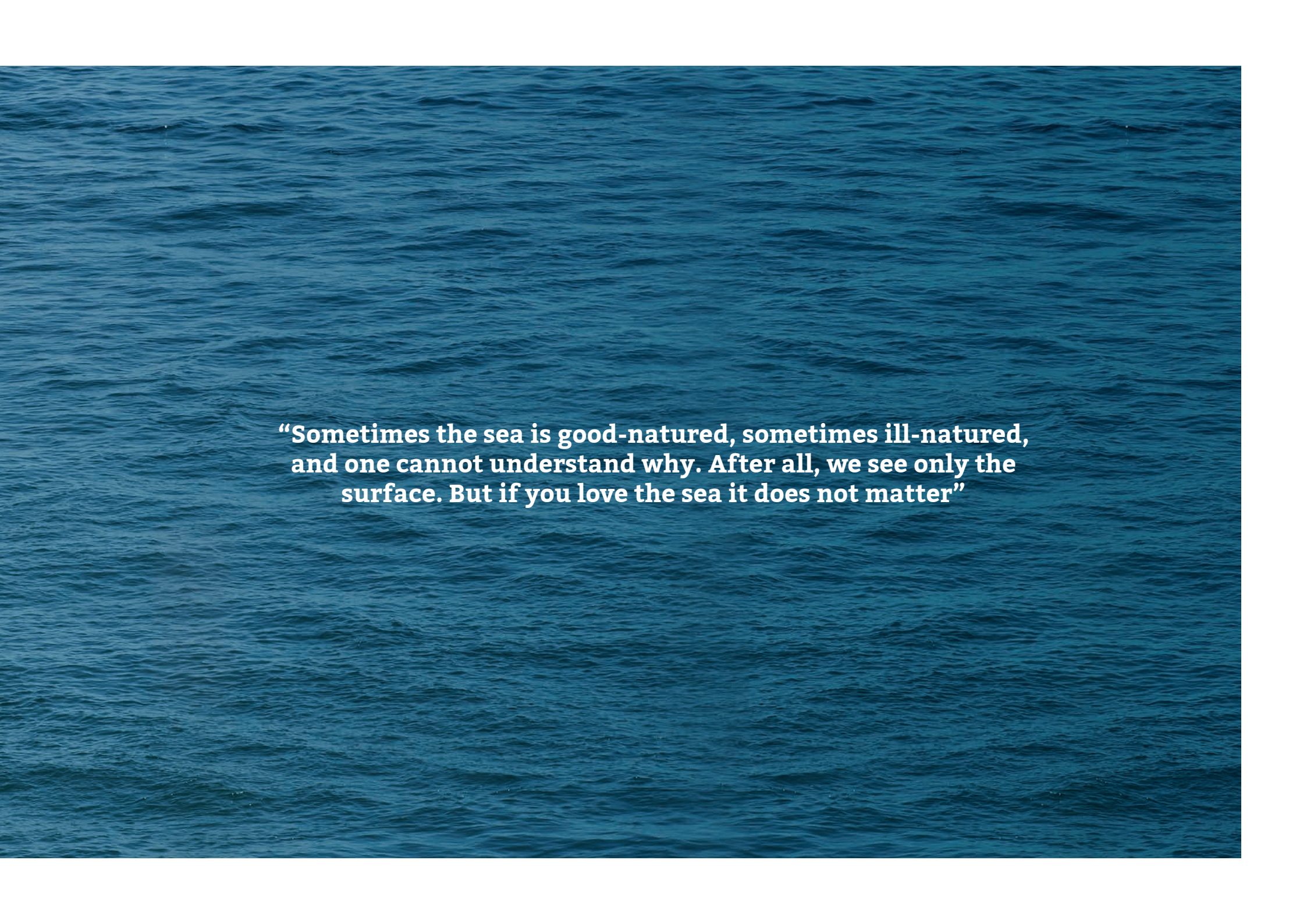

**“Sometimes the sea is good-natured, sometimes ill-natured,
and one cannot understand why. After all, we see only the
surface. But if you love the sea it does not matter”**

Specification

- **Length overall** — 14,40 m
- **Length of the hull** — 14,18 m
- **Width overall** — 3,82 m
- **Freeboard minimum** — 0,87 m
- **Air draft** — 5,0 m full / 3,95 m with folded mast
- **Clearance height (over cradle)** — 4,24 m
- **Transom deadrise angle** — 19,4 degrees
- **Displacement** — 13,9 t full / 10,8 t light
- **Fuel capacity** — 1750 l
- **Fresh water capacity** — 400 l
- **Engine** — 2 x Volvo Penta D6 (370 hp)
- **Passengers** — 10 persons





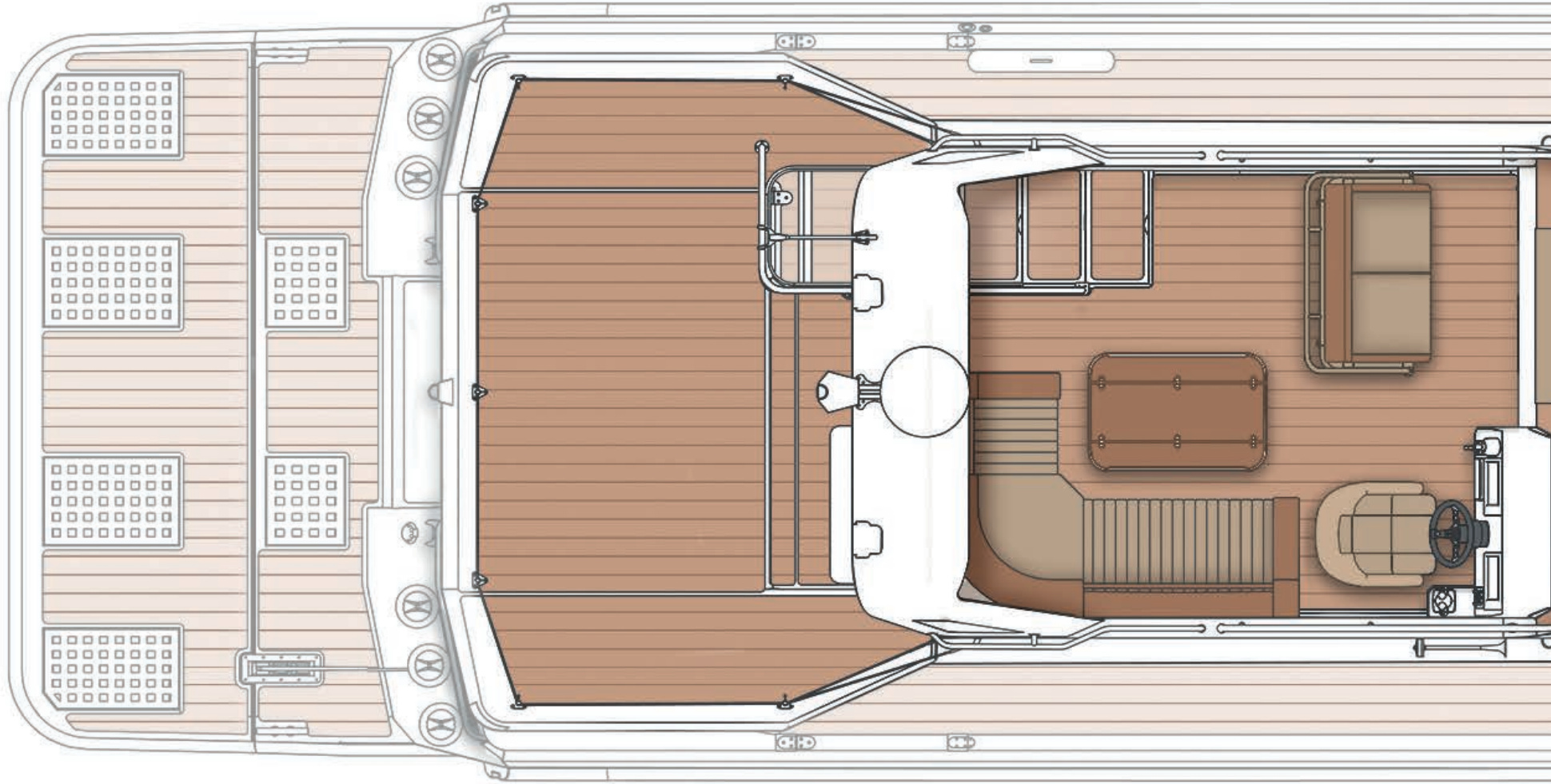

Life on the water

Versatility of the yacht is always related to the multi-purpose layouts and it is yet another strong point of NorthSilver 1440. Vegetation at rest is not her cup of tea; upon touching the water such boats immediately become part of the sea and follow its beat. That is the reason why the layout of NorthSilver 1440 is tuned for long staying on board. All the cabins and amenities are rationally designed, efficiently lit up and possess adequate ventilation. Form on this yacht always follows function striking a balance and even strict beauty of the finishing reflects certain ideas of the designers.

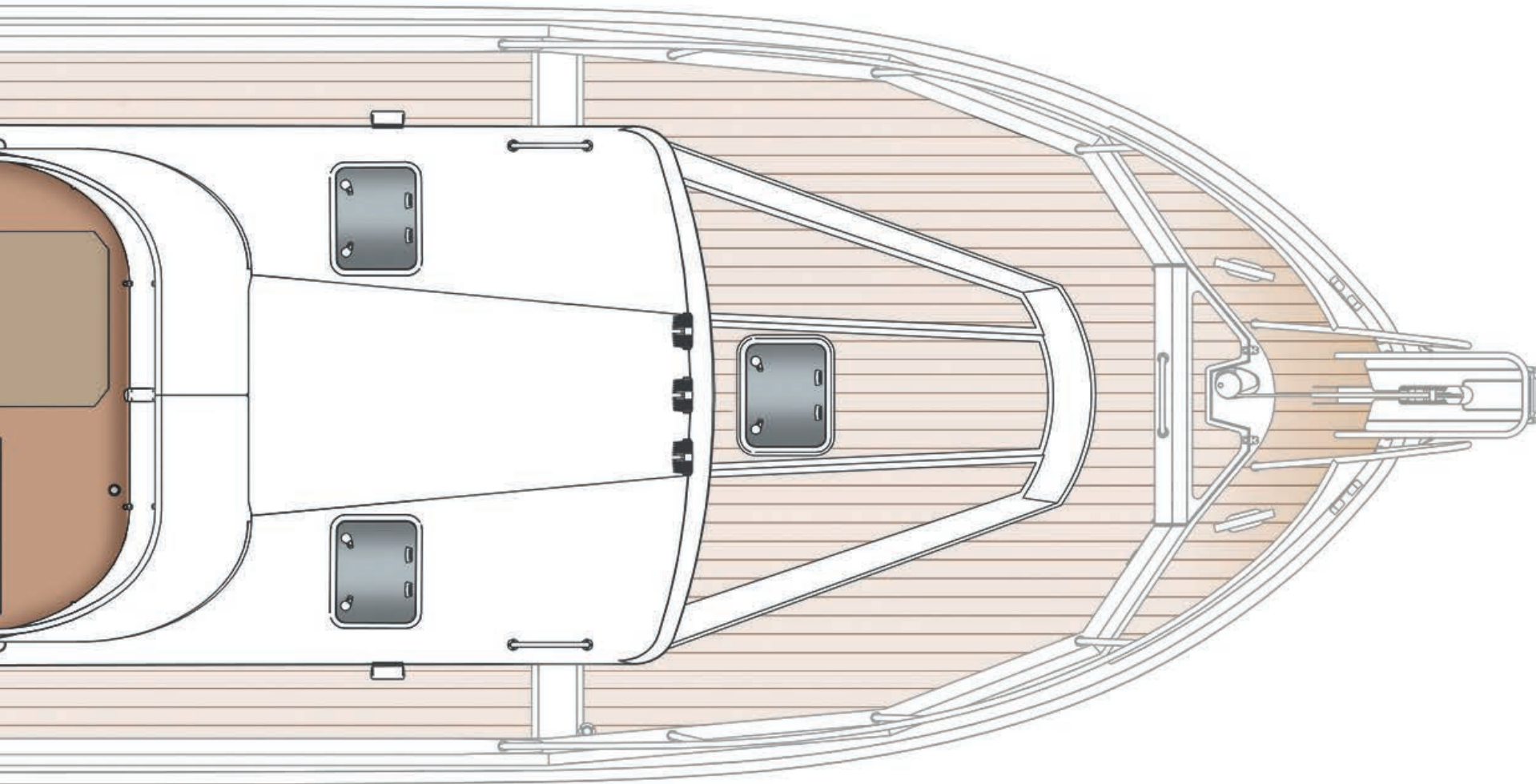

This also applies to the open decks where emphasis is placed on usability, safety and versatility. There is enough space for all passengers on the flybridge and its extensive overhang may act as the perfect platform for sunbathing. Obstruction-free open cockpit provides excellent access to the engine bay for daily checks and servicing through two large hatches with firm gas struts. Aft grabrail with wide gunwale has swing gates, fender baskets and permits installing grill and fishing rod holders. Transom platform features integrated anchor, swimming ladder and drain grids being a very natural place for the tender or PWC storage and carrying.

Main deck and access to both helm stations are set up in such a way that the helmsman could easily move across the vessel and cope with its handling single handed. But if you prefer to delegate this task to the hired skipper we already took care about his or her accommodation.

NorthSilver 1440 is extremely flexible yacht. We are always happy to meet the needs of our customers and fit their vessel up for any hobby or specific task. The sooner you would express your requirements, the better we would implement them.

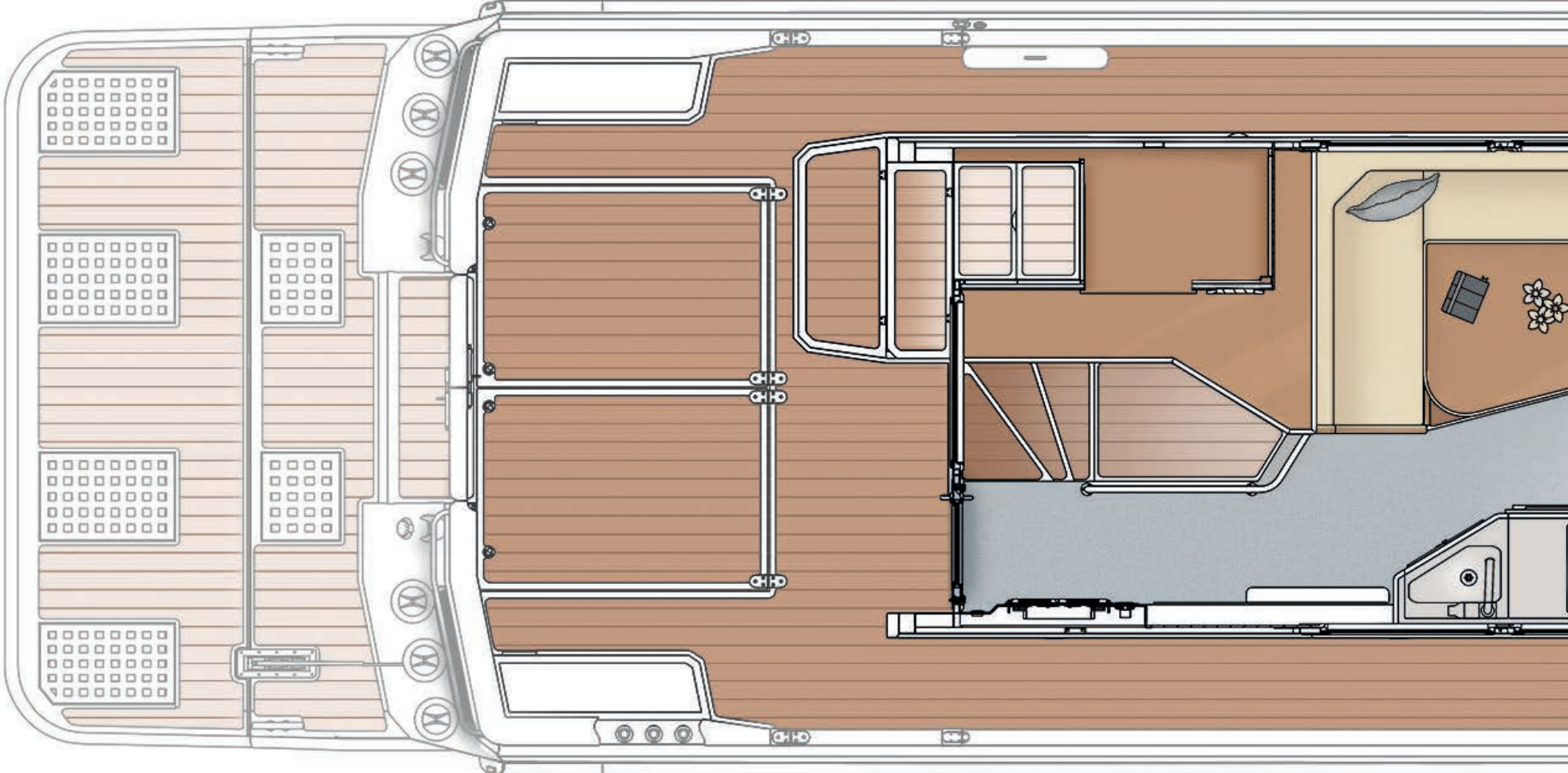

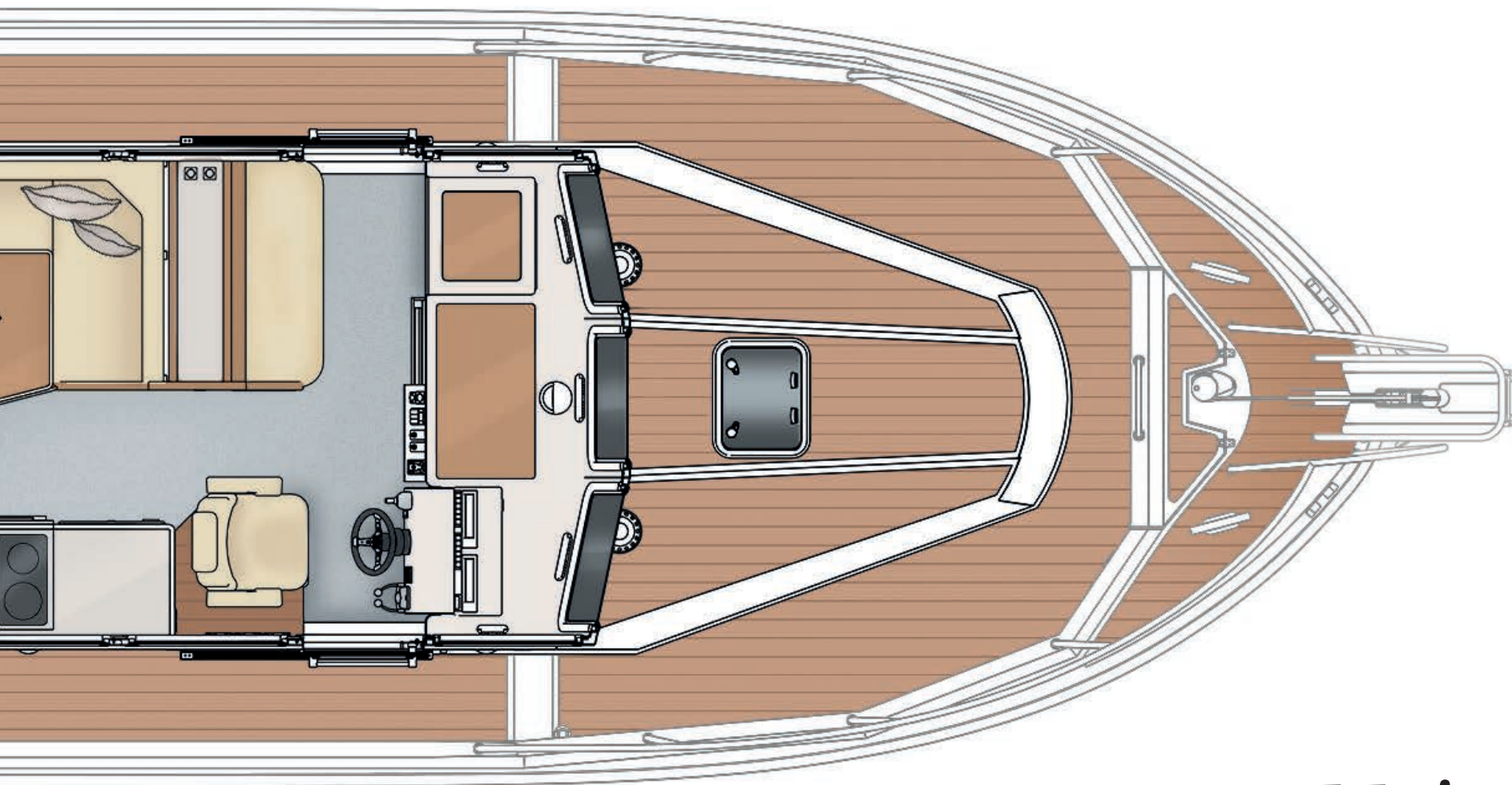

Main deck

Extensively glazed wheelhouse is completely isolated from the environment and boasts well equipped galley. Three wide sliding doors provide unrestricted mobility across the deck and comfortable double seat next to the helm allows navigator working with paper charts.

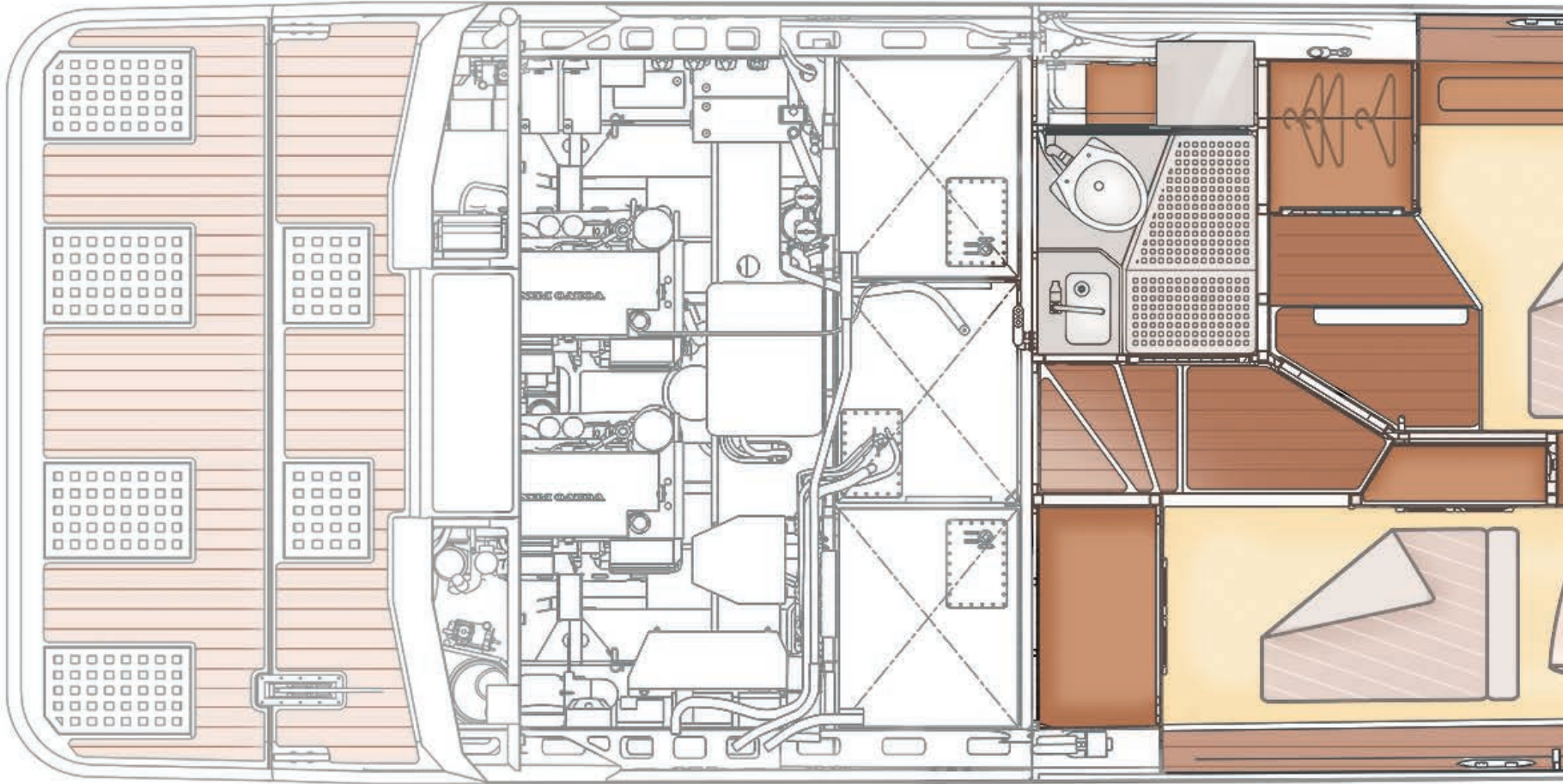

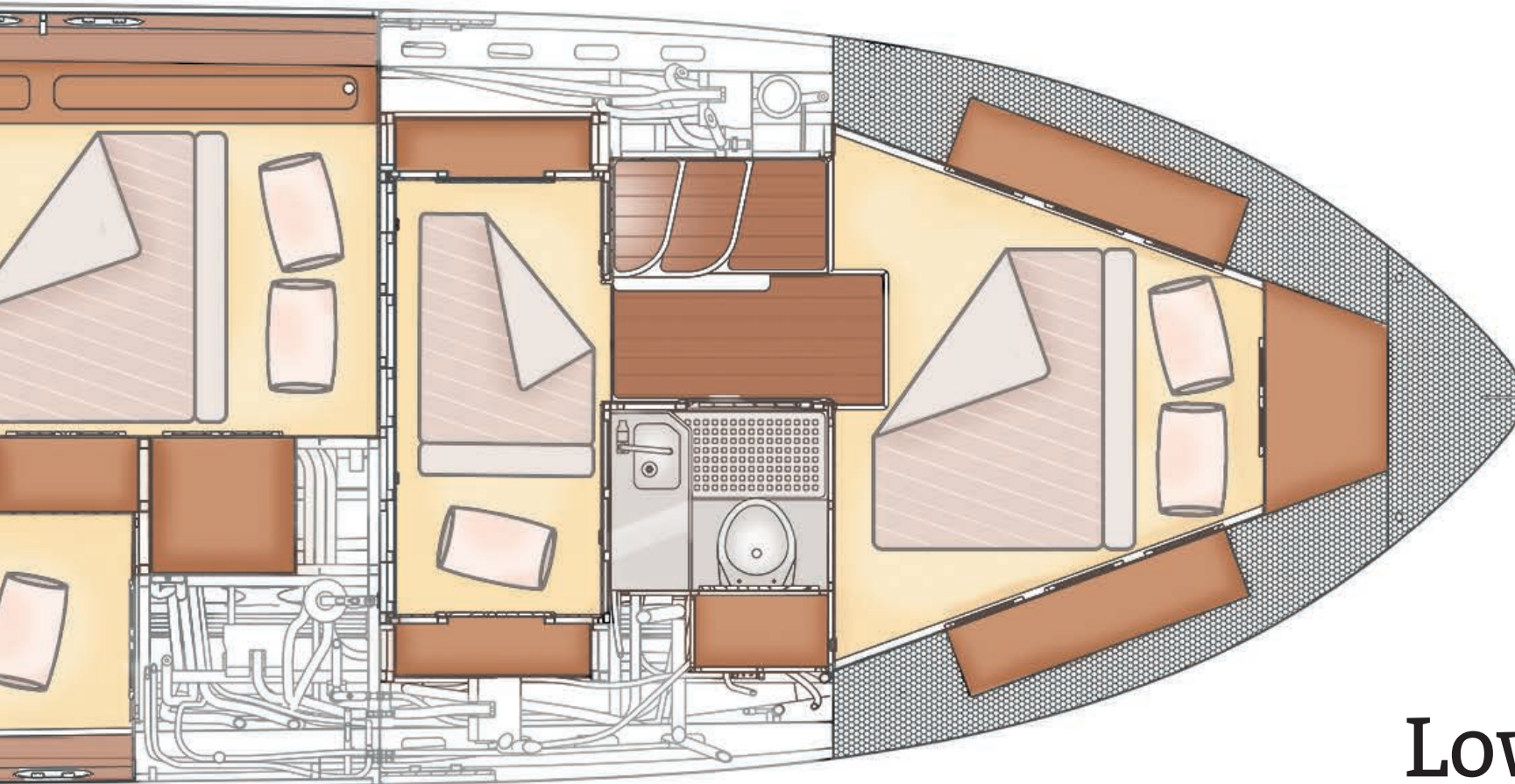

Lower deck

The vessel has six full size berths and two spacious heads which perfectly cover travel needs of a large family. In case when there are few passengers onboard unoccupied berths could be turned into voluminous holds for all kinds of stuff. There is separate access ladders for the aft and forward cabins which is very convenient when cruising with kids or having important guests.

Standard equipment

- Helm seat with shock absorbers
- Navigation lights
- Bilge pump system
- Galley
- Onboard power 12V/ 220V
- Windshield wipers
- Bow thruster
- Two electric anchor winches with rollers
- Swimming ladder
- Gunwale teak finishing
- Electric steering
- Audio system
- Ventilation hatch in the forward cabin
- Folding radar arch
- Water outlets for deck washing
- Diesel generator (3,2 kW)
- Boiler (40 l)
- Full specifications can be found on our website





GARMIN

NORTH SILVER 1700

NORTH SILVER



Not a toy, but a tool

It is unacceptable for us to leave any idle space on board.

That is why all usable room in and out is assigned for thought out storage, lockers, cabinets and drawers. They accommodate virtually the whole bunch of belongings needed for long cruises and the yacht turns from basic means of transportation into home on the water where one does not have to fall out of habitual things.



Comfort on the go

A good yacht should have not only well thought-out layout and high quality interiors without sharp corners. We have managed to make aluminum vessel less noisy as compared with similar fiberglass boats.

It is comfortable to stay in the wheelhouse both at anchor and while driving at top speed. At the same time comfort on board is enhanced with practical finishing made of teak, walnut and rosewood as well as wearproof Alcantara.



Route of **your choice**

NorthSilver 1440 is known for her exceptional seakeeping ability. Thanks to very sturdy hull with relatively high deadrise she can maintain fast cruising pace even in the high seas bringing passengers back home safe and sound. Our proven "4x4 of the sea" design was tested by the harsh real-life conditions of the Northern Atlantic and the lake Baikal.

Captain's **boat**

Choosing the best available marine electronics and neatly arranging instrument on the console we make all efforts to turn sailing into more intuitive and pleasing task regardless of the helmsman's previous experience. Extensive glazing and side doors in the wheelhouse as well as upper helm, joystick and bow thruster help to facilitate maneuvering in tight quarters and provide safer mooring.





GARMIN

NORTH SILVER 440

NORTH SILVER





GARMIN

VOLVO PENTA

GARMIN

LENCO

DOWN

UP

BOW

STERN

VOLVO PENTA

DOWN

UP

BOW

STERN



Fast and safe

The hull of the vessel was designed for proven Volvo Penta DPH stern drives which are in our view the most practical and relevant type of drives for northern seas. They are reliable, easy maintained and provide excellent dynamic performance as well as great maneuverability. We can also equip the yacht with pod drives and even with water jets if requested by the customer.

Unlimited cruising

The yacht is tailored for prolonged cruising even with standard equipment. We offer a number of ways to increase self-sufficiency including rising fuel tanks volume by 30%, installing overboard water intake system and capacious freezers. The low dependence on shore infrastructure broadens the usage scenarios and allows reaching remote destinations.

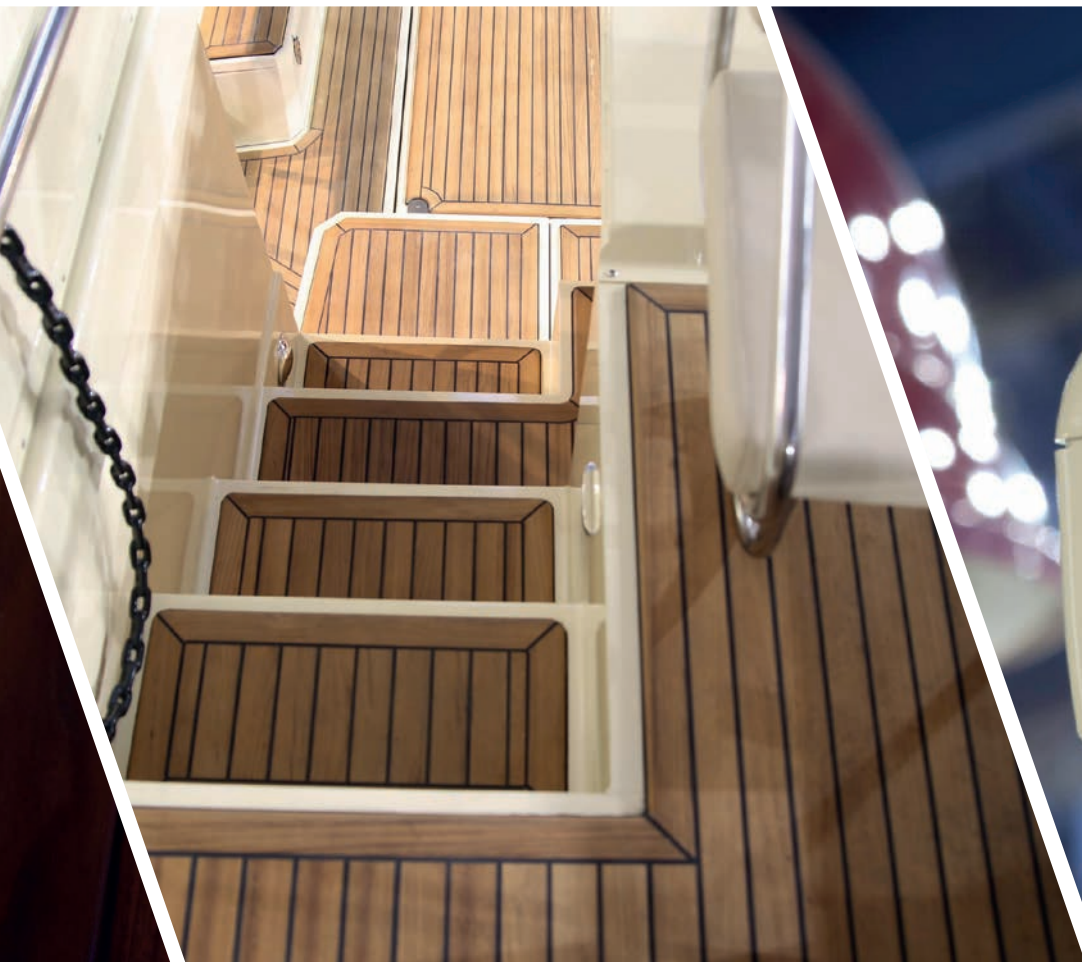

Space for life

High bulwarks, solid grabrails, wide side decks, spacious cockpits and abundance of handrails permit safe moving across the vessel in every kind of weather. Furthermore, usability of the yacht could be enhanced by the addition of the flybridge extension and bowsprit platform with removable ladder while foldable radar arch allows passing under low bridges.

Endless possibilities

We are ready to rig the vessel for completing any kinds of tasks and offering broad range of additional equipment including hydraulic transom platform, independent heater, air-conditioning unit, thermal and CCTV cameras, satellite TV set, high output generator to connect washer\dryer, induction cooktop, extra fridges, wine cellar, and other devices with high current drain.





NORTH SILVER 1440











NORTH SILVER

GARMIN



















NORTH SILVER

NORTH SILVER 1440



NorthSilver

Vyborgskoe shosse, 362

Saint Petersburg, Russia, 194362

+7 (812) 244-35-65

eu@silverboats.ru

www.silverboats.ru